

Open Web Device

Data Usage

Data Usage

Document Revisions

V1	Jul 10 2012	Rafael Rebolleda	Recap based on Marco's and Ayman's work
V2	Jul 12 2012	Rafael Rebolleda	IA rework
V3	Jul 13 2012	Rafael Rebolleda	Expanding on current ideas.
V4	Jul 13 2012	Rafael Rebolleda	Refined IA and controls
V5	Jul 17 2012	Rafael Rebolleda	Better toggling of limits and warnings Interface toggle acts upon the graph *and* the list below Tethering demoted. Now displays in the list like any other app Graph labeling Better WiFi toggles in app break-down list Change document name to "Data Usage" instead of "Document Management"

Data Usage

Overview

All information depends on the interface toggles and the data range selected. Any change in both variables will update the graph, the amounts, the order of the per-app break down and totals.

interfaces not displayed in the chart are dimmed out
this toggle affect **both** the graph and the list below
swipe to see daily bar graph and per interface pie chart
scale will adjust automatically with sustained dragging up of limits and/or alerts. likewise, it'll readjust when dragging down

title should match selected interfaces

tethering

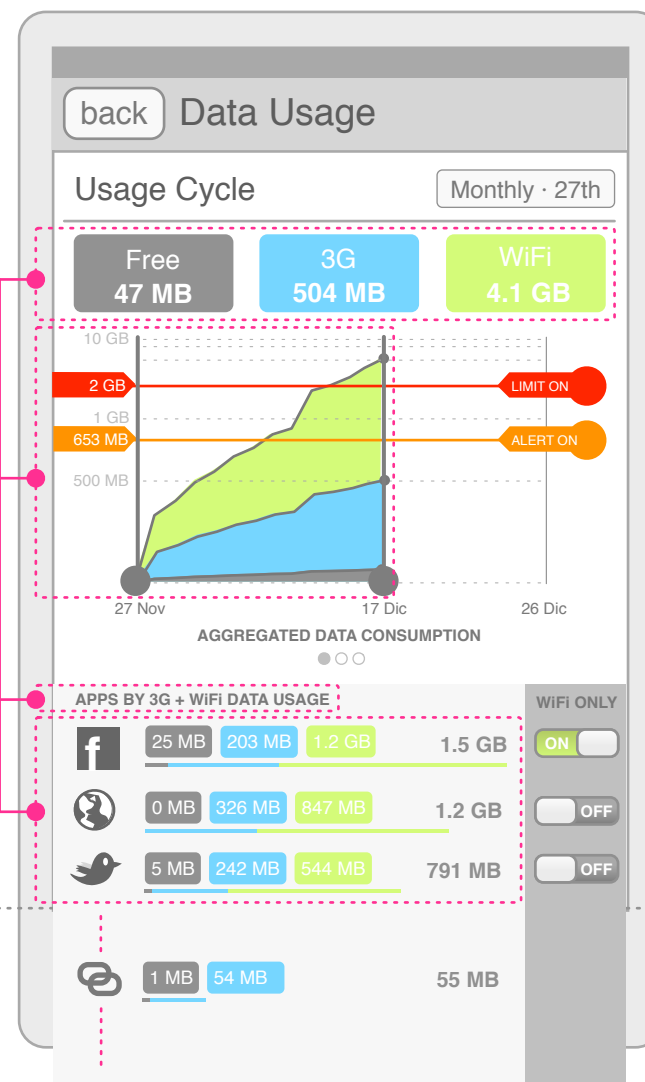

tap to set time scale and recurrence (day of month or week)

tap to toggle display

drag up/down to adjust (an overlay with the figure will pop up)
tap to turn on and off
tap and hold to enter exact value

data range affects both chart and break down below

apps **ordered by added (per toggled on interface)** data consumption. longest bar defined by the app with biggest data usage in selected interface(s) and date range. Total only displayed when multiple are selected.

tethering doesn't have wifi only option (makes no sense)

all data displayed in the list corresponds to the selected range and interfaces

Data Usage

First Time Setup

By default there are no limits nor warnings set up, but we can track usage from day 0. Chart scaling could be adjusted vertically, depending on data range, and must be adjusted horizontally, depending on billing cycle.

default cycle is first day of each month
display 3G only by default

limit and alert off
tap to enable

default range:
beginning of cycle to current day

no app is wifi only by default

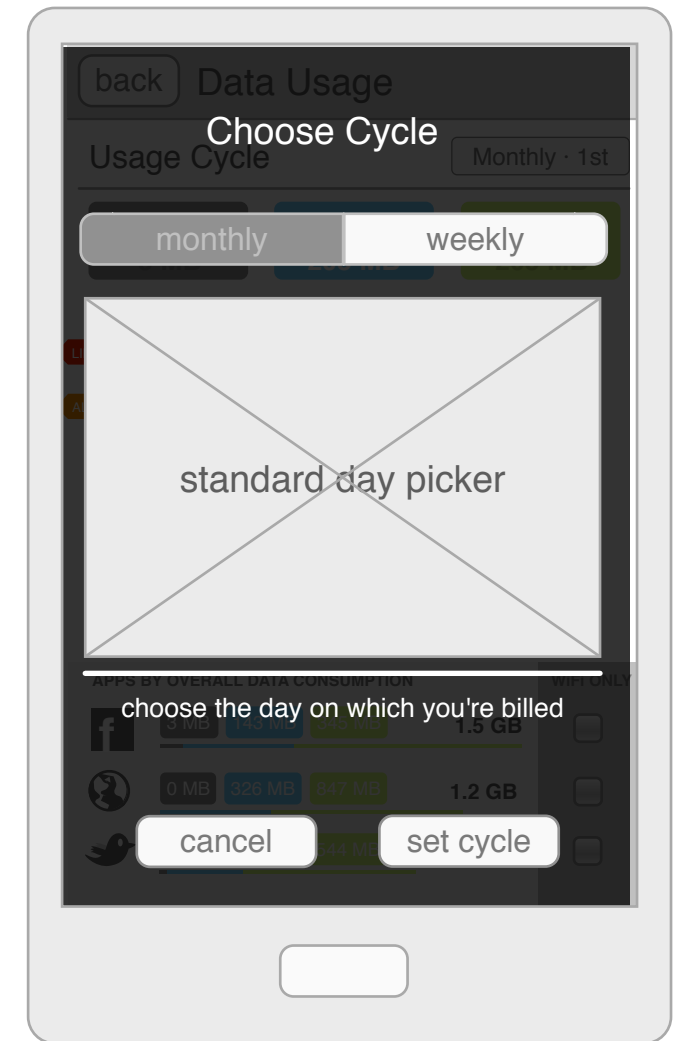
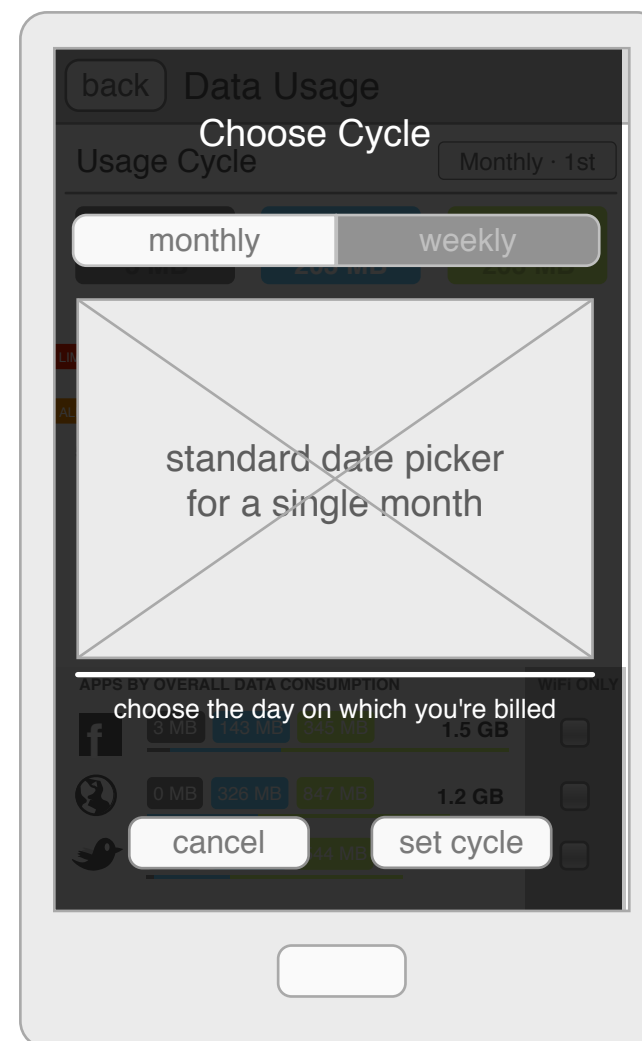
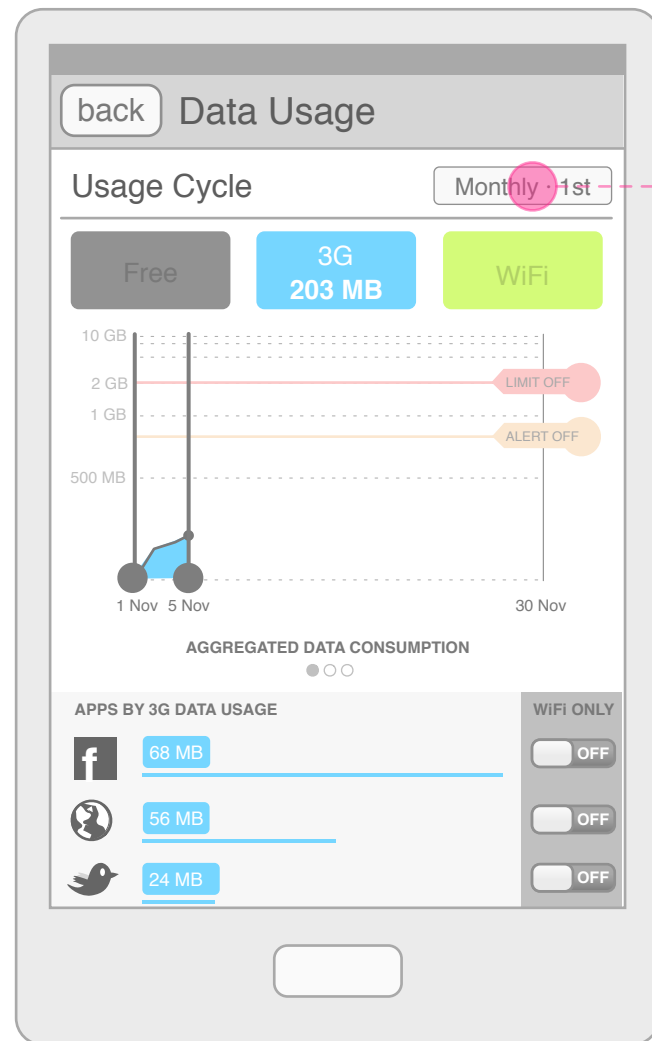

Data Usage

Setting Up Limits And Warnings

toggle limit and warning by tapping

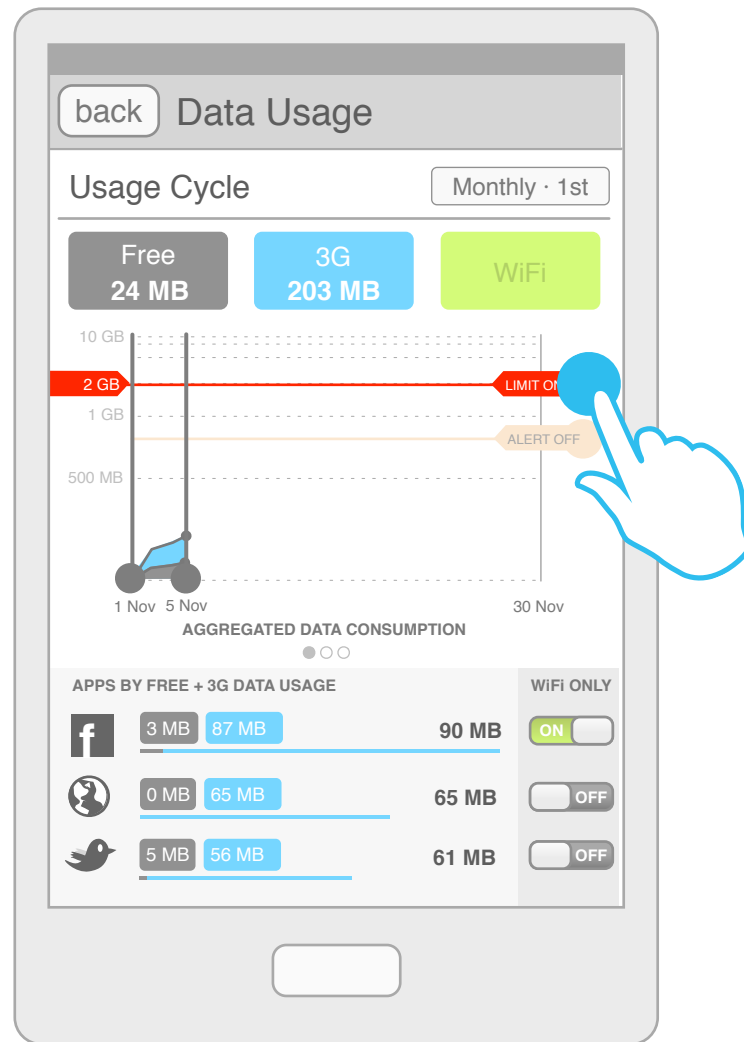

a notification should warn about different measures by the phone and carrier

adjusting limits and alerts

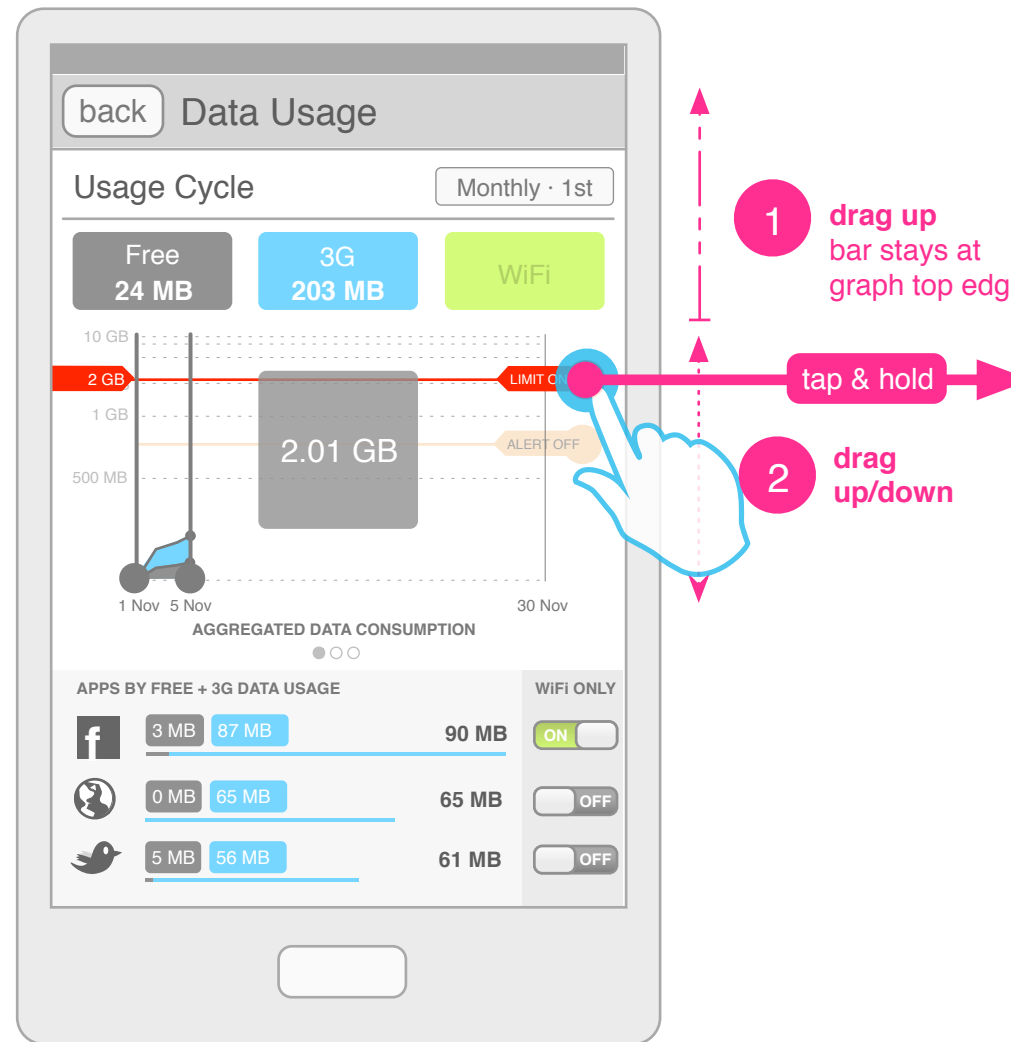

- 1 sustained dragging on the top edge of the chart will increase the scale on y axis
- 2 once the drag has finished, the scale on y-axis will always autoscale to best fit i.e. dragging down to 600MB when the scale is 10GB will refactor it down
- 3 display accurate value while dragging

tap and hold to enter exact value

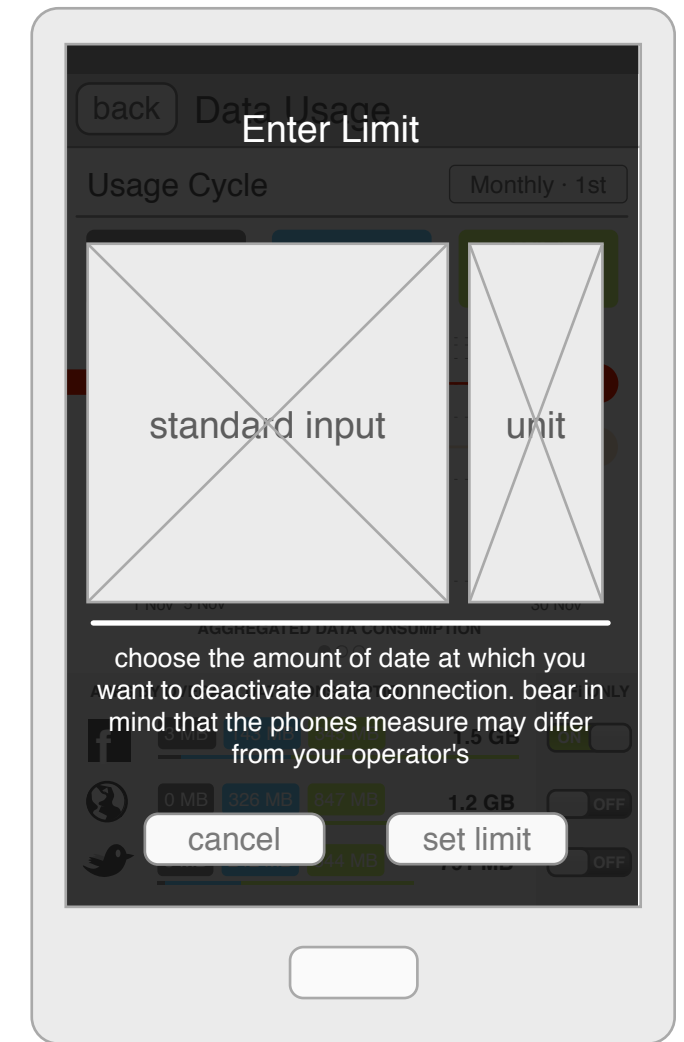

Data Usage

Chart Types

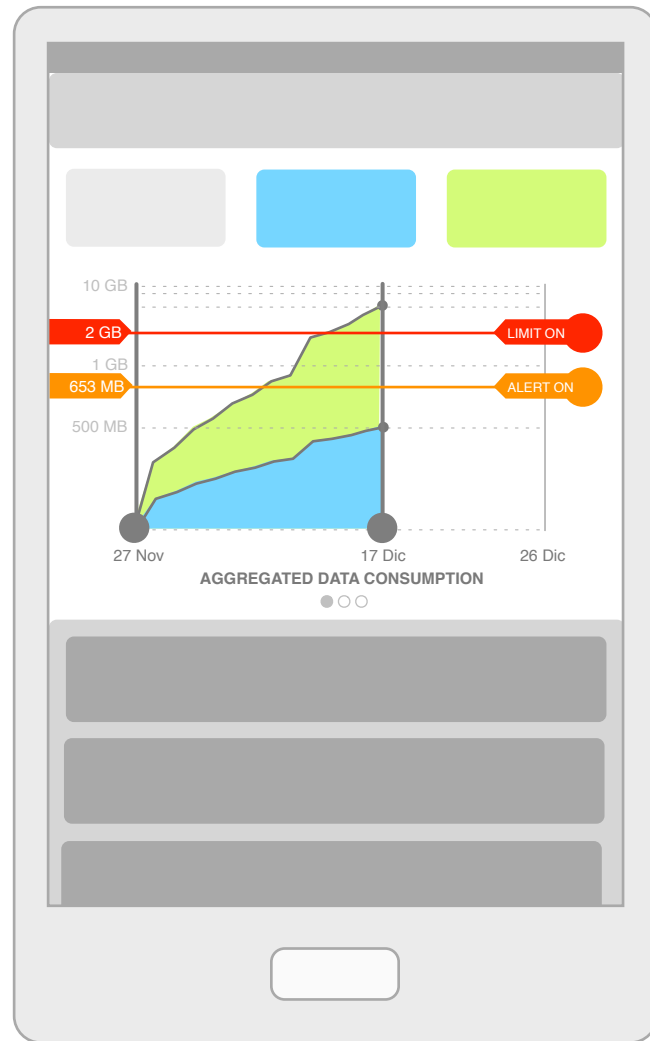

aggregated data usage on a logarithmic scale
limits per aggregated monthly/weekly usage

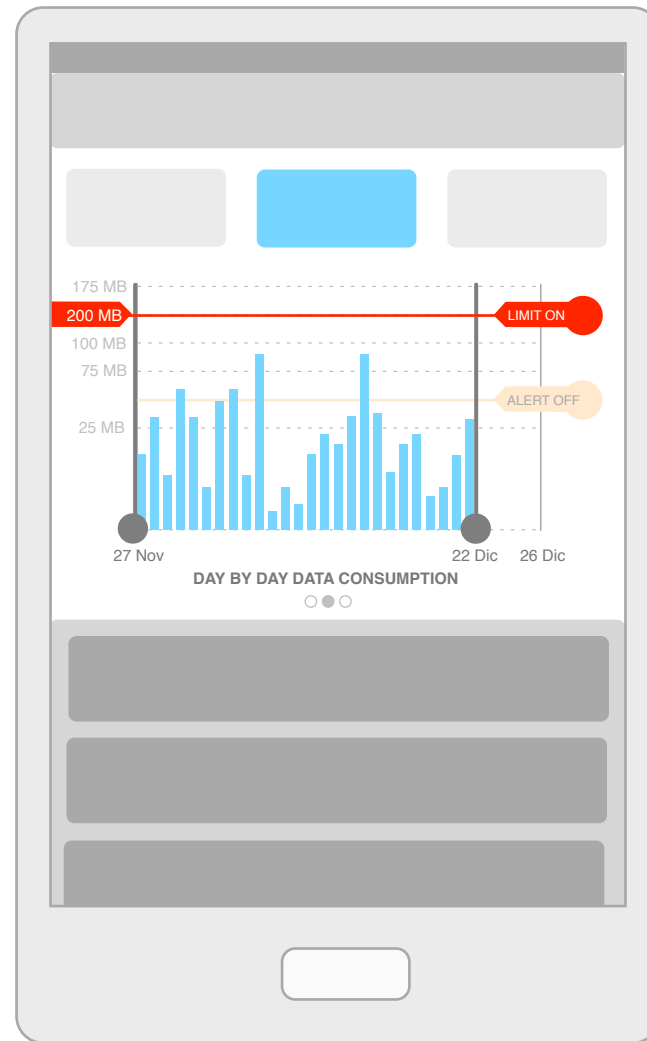

day by day usage on a linear scale
limits per day

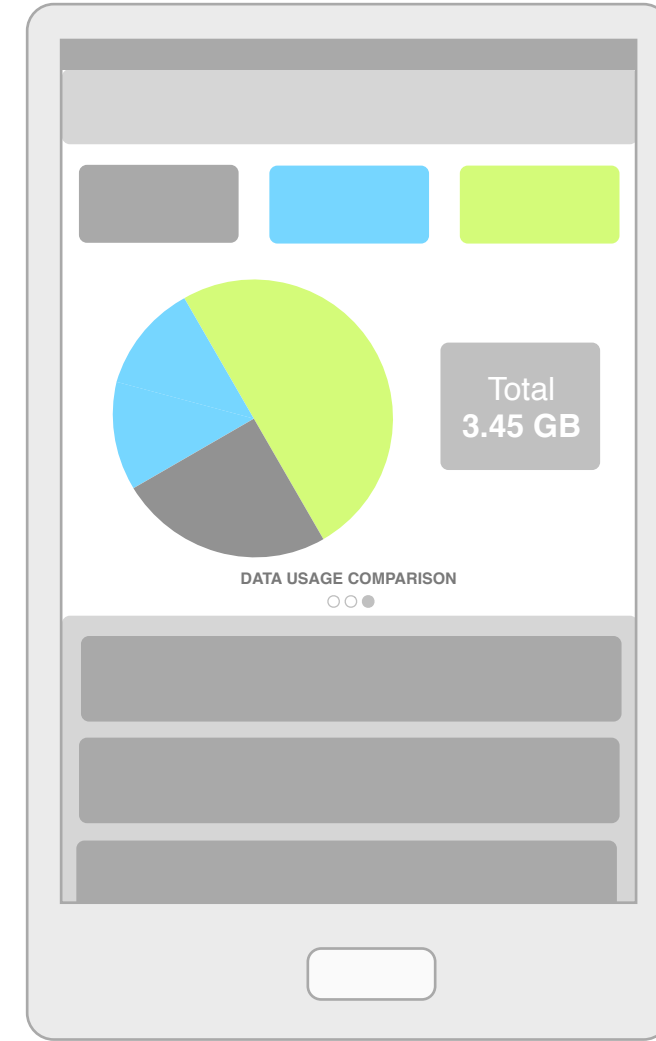

data usage comparison
between interfaces